

SWIMMING Waterpolo Readability 35 m
WATERPOLO

W-TOP Battery

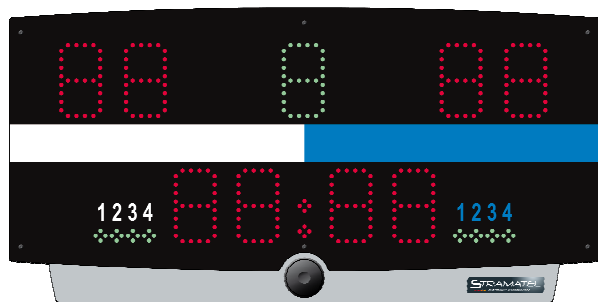

(non contractual picture)

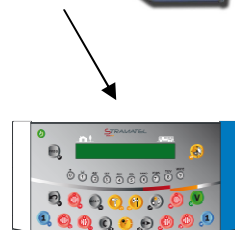

Composition

- 1 portable scoreboard with retractable control console
- 1 Battery charger
- Operating instructions



Description

Use :	Indoor
Transmission :	Direct
Readability :	35 m, angle >160°
Dimensions :	730 x 370 x 110mm
Weight :	5.5 kg
Power supply:	Integrated Built-in lead-acid batteries 2 x 6V 4,5Ah (about 20 hours capacity).
Protection :	Unbreakable mat polycarbonate front face
Integrated buzzer :	86 dB at 1 m

Display functions

Score :	2 x 2 red LED digits (9 cm)
Period :	1 green LED digit (9 cm)
Timer/Rest period :	4 red LED digits (9 cm) + 2 blinking points
Time outs :	2 x 4 green points
Teams indication:	white and blue stickers

Control consoles

1 retractable console :	(340 x 175 x 60 mm) with LCD screen with 2 lanes of 20 characters (9 mm high)
USB Port:	For programme update
Programme:	Waterpolo / Swimming training / Timer function
Multilingual Programme	

Options

30 sec shot clock :	The W-Top is synchronisable with: SC30 Eco, cable controlled with external horn SC30 Battery Autonom, radio controlled integrated horn.
----------------------------	---